

SPC820S

Axial/semi-open impellers

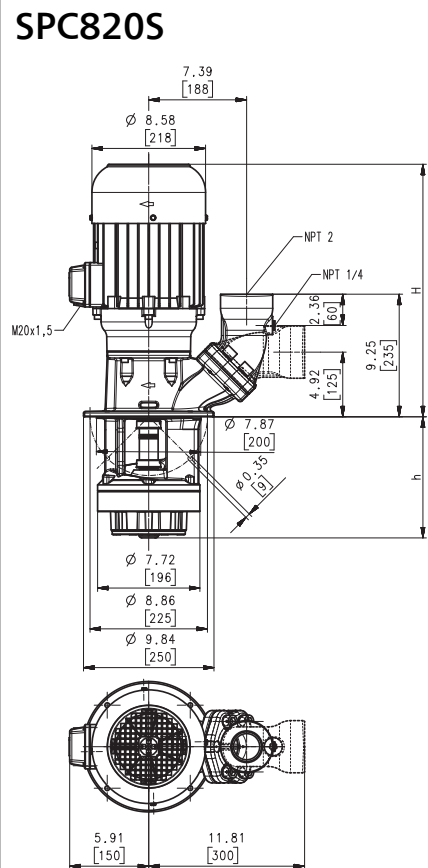

60 Hz



Dimensions in Inches / mm

Type	Flow at head	Height	Depth of im-mersion		Weight		Power	Voltage 3 ~	Fre-quency	Current	Speed
	GPM /Feet l/min /m	H inch mm	h inch	h mm	Lbs	kg					
SPC820S230	100/32 400/9.5	19.8 503	9.13	232	156.6	71	5.1	230	60	12.8	3520
330			13.07	332	161.0	73	3.8	460	60	6.4	3520
460			18.19	462	165	75					



Cutter Pumps

The cutter pumps of the **series SPC** are designed to handle and reliably cut long, stringy plastic chips. The higher number of cutting blades results in an increased cutting frequency of all chips to be consistently cut into small pieces. The SPC pumps are equipped with the user-friendly 45 degree **flange** connection which allows for either vertical or horizontal pipe connection and the connection of a pressure gauge. For more information see lifting pumps features SXC/SPC within the technical information section.

Applications

Types of fluid
coolants
cooling/cutting oils
Max. chip to coolant ratio by weight:
0.3 %
Chip material:
Plastic
Kinematic viscosity
...140 SSU (...30 mm²/s)
Pumping temperature
30...140 °F (0...60 °C)

Construction

Pump body	cast iron
Cover	cast iron
Impeller radial	cast steel
Cutting unit	Hardened (>60 HRC)
Shaft	steel

